

# LED LR40-RGBW 610 PMMA<sub>d</sub>-M12-57

Art. Nr. 1-000000-06973

Ktl. Nr. 15070984

EAN Nr. 4260654163766

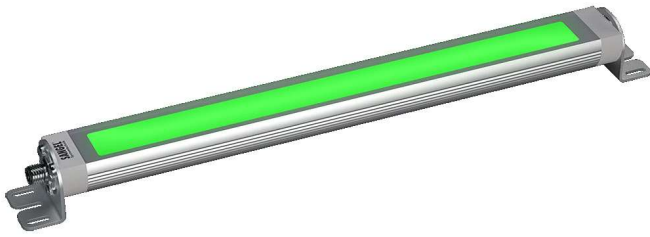

## Normen / Norms

DIN EN IEC 60598-1

DIN EN IEC 55015

DIN EN 61547

DIN EN 62471



## Elektrische Rahmenbedingungen / Electrical characteristic

Netzanschluss / Main Supply	24 VDC
Leistung / Power (W/R/G/B)	17,2W / 8W / 7,9W / 7,7W
Dimmbar / Dimmable	extern PWM
Anschluss / Connection Type	Flansch, M12, 5-Pol, A-Codiert
Kaskadierbar / Cascadable	Nein
Polbild	

## Licht / Light

Bestückt / Fitted With	LED
Lichtfarbe / Light Colour	5000 K
Lichtstrom / Luminous Flux (W/R/G/B)	1051lm / 122lm / 338lm / 75lm
Effizienz / Efficiency	39 lm/W
Abstrahlwinkel / Beam Angle	100°
Farbtreue / Colour Rendering	RA / CRI 80
Photobiological Safety	RG-1

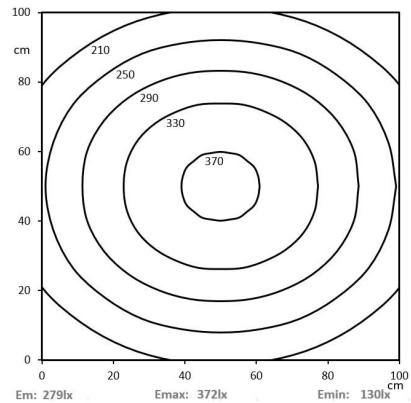

## Mechanik / Mechanics

Gehäuse / Housing	Aluminium
Abdeckung / Cover	PMMA, Diffus
Befestigung / Fastening	Drehbar
Gewicht(Netto) / Weight(Net)	0,73 kg
Betriebstemperatur / Operating Temp.	-20°C / +45°C
Lebensdauer / Lifetime	min. 60000 h
Zubehör / Equipment	Winkel inkl.

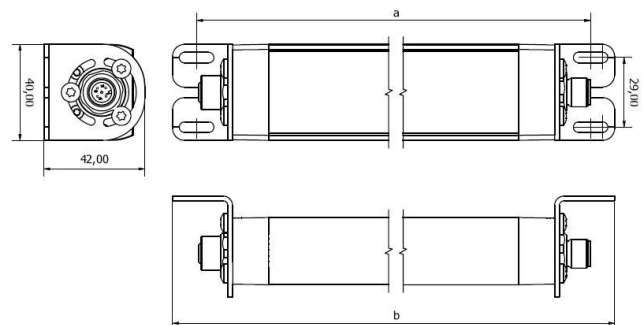

a = 640mm b = 660mm

\*Technische Änderungen vorbehalten | technical modifications reserved